



The Performing Arts Education Center  
on the campus of Agoura High School (A-PAEC)

Main Stage Theater

Technical Specifications

## **Table of Contents**

### **I. General**

a. House Policies _____	04
b. Crew Breaks and Meal Penalties _____	05
c. Holidays _____	05
d. Last Minute Changes to Schedule _____	05
e. First Aid _____	05
f. Loading _____	06
g. Parking _____	06
h. Addresses _____	07
i. Contact Information _____	07
j. Site Map _____	08
k. Building Layout – First Level _____	09
l. Building Layout – Second Level _____	10
m. Building Layout – Third Level _____	11

### **II. House**

a. Seating Capacity _____	12
b. Sections _____	12
c. Handicap Seating _____	12
d. Acoustic Curtains _____	12
e. Tech Table Position _____	12
f. WiFi Access _____	12
g. Seat Map _____	13

### **III. Backstage**

a. Dressing Room 1 _____	14
b. Dressing Room 2 & 3 _____	14
c. Green Room _____	14

### **IV. Stage**

a. Floor _____	15
b. Critical Dimensions _____	15
c. Orchestra Pit Elevator _____	15
d. Drapery _____	16
e. Company Switch _____	16
f. Orchestra Shell _____	16
g. Dance Floor _____	16

### **V. Rigging**

a. Single Purchase Counterweight Line Sets _____	17
b. Prodigy Hoist _____	17
c. Transverse Line Sets (Light Ladders) _____	17
d. Line set Schedule _____	17-18

VI. Lighting	
a. Control	19
b. Data	19
c. Main Dimmer Racks	19
d. Portable Dimmer Rack	19
e. Distribution	19
f. Four (4) Onstage Dedicated Electrics	19
g. #0 Electric (Prodigy Hoist)	19
h. Cyc Lights – Fifth Electric	19
i. Three (3) Aps (Front of House Electrics)	19
j. Two (2) Box Booms (Side Lighting Positions)	19
k. Light Ladders	20
l. Net 3 Gateway Nodes	20
m. Rep Plot – Description	20
n. Inventory	20
o. Follow Spot Lights	20
p. Circuit Layout	20-21
VII. Audio	
a. Mixing Console	22
b. Amplification	22
c. Playback/Recording	22
d. Distribution	22
e. XLR Patching	22
f. Microphone Lines	23
g. Tie Lines	23
h. Monitor Patching	23
i. Microphone Inventory	24
j. Audio Equipment Inventory	24
VIII. Projection/Video:	
a. Front Projection	25
b. Rear Projection	25

**GENERAL:**

HOUSE POLICIES

Everyone who uses the buildings becomes a de facto member of the LVUSD Performing Arts Community and, as such, is expected to behave in a manner that is consistent with LVUSD standards and professional theatre best practices. You must do your utmost to protect the building, the equipment, and to encourage a positive experience for our students, patrons, and staff. Please adhere to the following guidelines while working in the PAECs:

1. NO feet on the backs of chairs.
2. Aside from bottled water, NO food or drink inside the theaters. \*If food or beverage service is desired backstage, all arrangements must be cleared in advance with PAEC Management.
3. NO smoking or alcohol is allowed anywhere on school campus, including the PAECs.
4. Leave the space as clean as you would expect to find it when you return for your next opening night.
5. The lobby opens one (1) hour prior to the scheduled show time, and the house opens for patrons to take their seats thirty (30) minutes prior to the scheduled show time. If you desire a different schedule, you must arrange for this with the Event Coordinator prior to the day of your show.
6. Prior to opening the house, the appropriate representative (i.e., teacher, stage manager, company manager, etc.) of the performing company shall be notified by the staff member of The Performing Arts Education Center responsible for the Front-of-House operations (e.g., Theatre Manager, Event Coordinator, etc.).
7. A late seating policy will be established by the Performing Arts Education Center staff responsible for the Front-of-House operations in concert with the appropriate performing company representative (i.e., teacher, stage manager, company manager, etc.) and will be in force during every performance.
8. NO unauthorized guests backstage. Artists and crew should meet their guests in the lobby, at the Backstage Corridor entrance, or outside the Artists' Entrance following each show.
9. Any group using the facility will be held responsible for any damage to the facility that occurs during their stay.
10. Orange electrical outlets must not be used.
11. DO NOT attempt to connect to a PAEC Ethernet port before consulting with a PAEC staff member.
12. Any group using the facility is required to adhere to all Las Virgenes Unified School District Fire-Life-Safety policies.

**Crew Breaks and Meal Penalties:**

Any crew person working in excess of six (6) hours shall be entitled to an uninterrupted Meal Break at or about the midpoint of each work shift.

A Meal Break must be called between three (3) and five (5) hours into any work shift. If a Meal Break commences beyond five hours into a work shift, a Meal Penalty of one additional hour per crew person will be assessed as part of EXPENSES for every hour or portion thereof of work over the fifth hour.

Meal Breaks are one (1) hour off the clock. However, a one-half (1/2) hour “working meal” may be called for any crew member, provided each “working meal” is on the clock and the PRODUCER feeds each applicable crew member.

A break of Fifteen (15) minutes must be given, on the clock, every two (2) to three (3) hours during the work shift, depending on the meal break schedule.

**Holidays:**

New Year’s Day, Martin Luther King Day, President’s Day, Memorial Day, Independence Day, Labor Day, Veteran’s Day, Thanksgiving Day, and Christmas Day are considered official holidays.

The base rate for labor requests on these days will be billed at one and one-half (1 1/2) times the established hourly rate.

**Last-minute changes to schedule**

The producer is required to inform the Theater Manager or his designated representative of any changes to the schedule as soon as possible.

Any changes made after 48 hours of the time of the event will result in you paying crew for time worked OR scheduled time regardless of actual time worked, whichever is greater.

**FIRST AID:**

There is a First Aid Kit Located on the Stage Right Wall for your use. Misuse of any kit items will not be tolerated.

Should any use of supplies be deemed wasteful by PAEC staff, charges for these items may be incorporated into the settlement for the event.

We strongly encourage producers to provide your own ice packs for dancers for non-emergencies.

**Loading:**

The loading dock is located on the West side of the Building adjacent to the soccer field. Enter the Upper Lot from West Driver and follow the drive along the north side of the building.

Access is at ground level (i.e., no raised loading dock platform) through the Freight Elevator via the 15' Wide by 10' High loading door.

The stage is accessed from the Freight Elevator through the 10' Wide by 16' High rolling stage door on an upstage right wall of the theatre.

**Parking:**

Free, surface-level patron parking is available adjacent to the Performing Arts Education Center during events.

Parking for A-PAEC events are accommodated within the scheduling and spaces available at the site. If special or additional parking arrangements are required, additional fees may apply.

The PAEC provides complimentary Parking Passes for up to 6 cars for calls scheduled during school hours, upon request.

**Addresses:**

Location:

The Performing Arts Education Center  
on the campus of Calabasas High School  
28545 W. Driver Ave.  
Agoura Hills, CA 91301

Mailing Address:

The Performing Arts Education Centers  
Las Virgenes Unified School District  
4111 North Las Virgenes Rd.  
Calabasas, CA 91302

**Contact Information:**

**Theater Manager**

Gilles Chiasson  
APAEC (818) 889 – 8058 ext 2  
CPAEC (818) 591-1209, ext. 2  
theatermanager@lvusd.org

**A-PAEC Technical Director**

James Auld  
(818) 889-8058, ext. 3  
jauld@lvusd.org

**A-PAEC Box Office**

(818) 889-8058, ext. 1

**C-PAEC Technical Director**

Brian Ludmer  
(818) 591-1209, ext. 3  
bludmer@lvusd.org

**C-PAEC Box Office**

(818) 591-1209, ext. 1

Performing Arts Education Center (A-PAEC)  
on the campus of Agoura High School  
28545 West Driver Avenue  
Agoura Hills, CA 91301

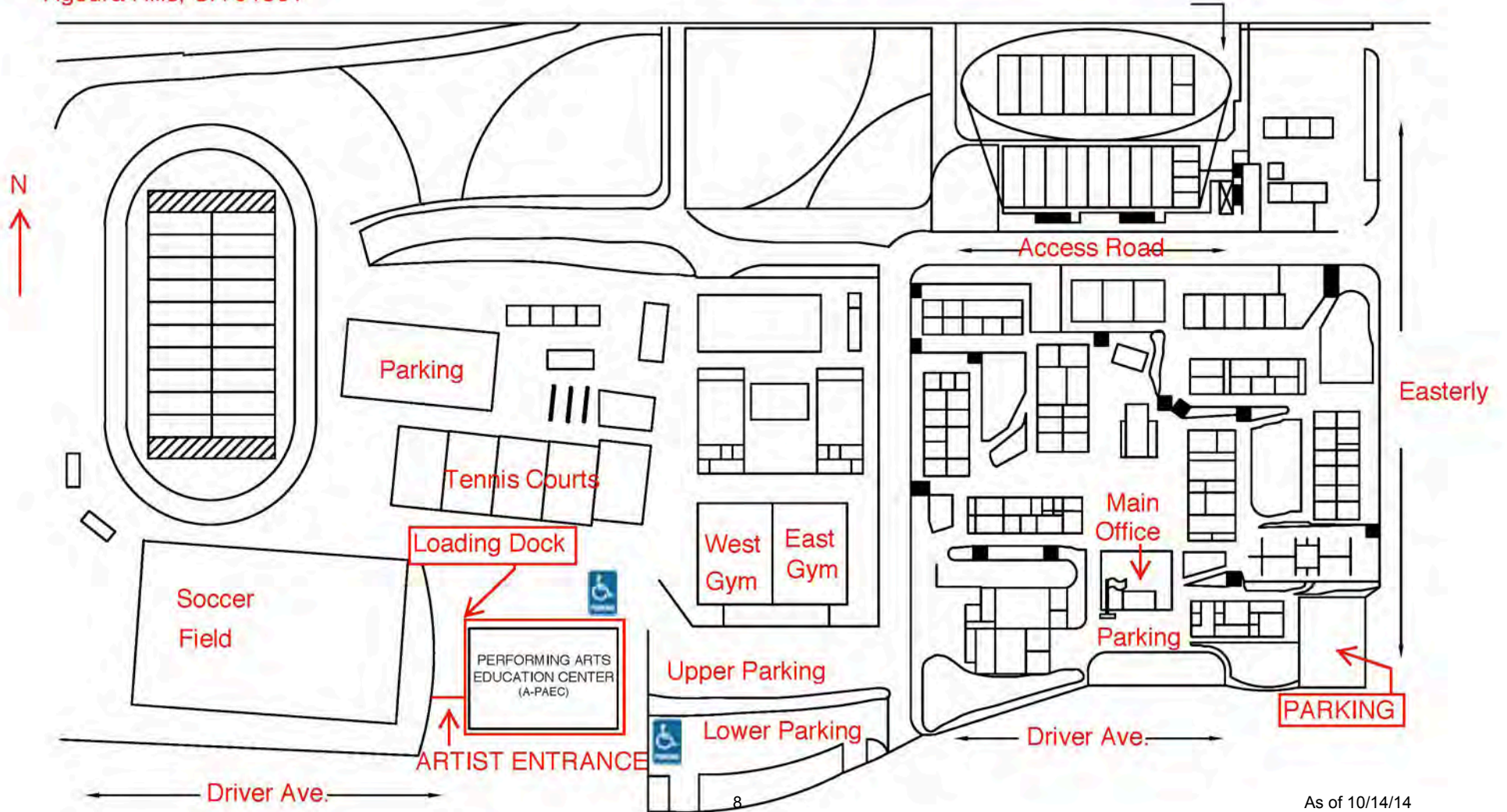



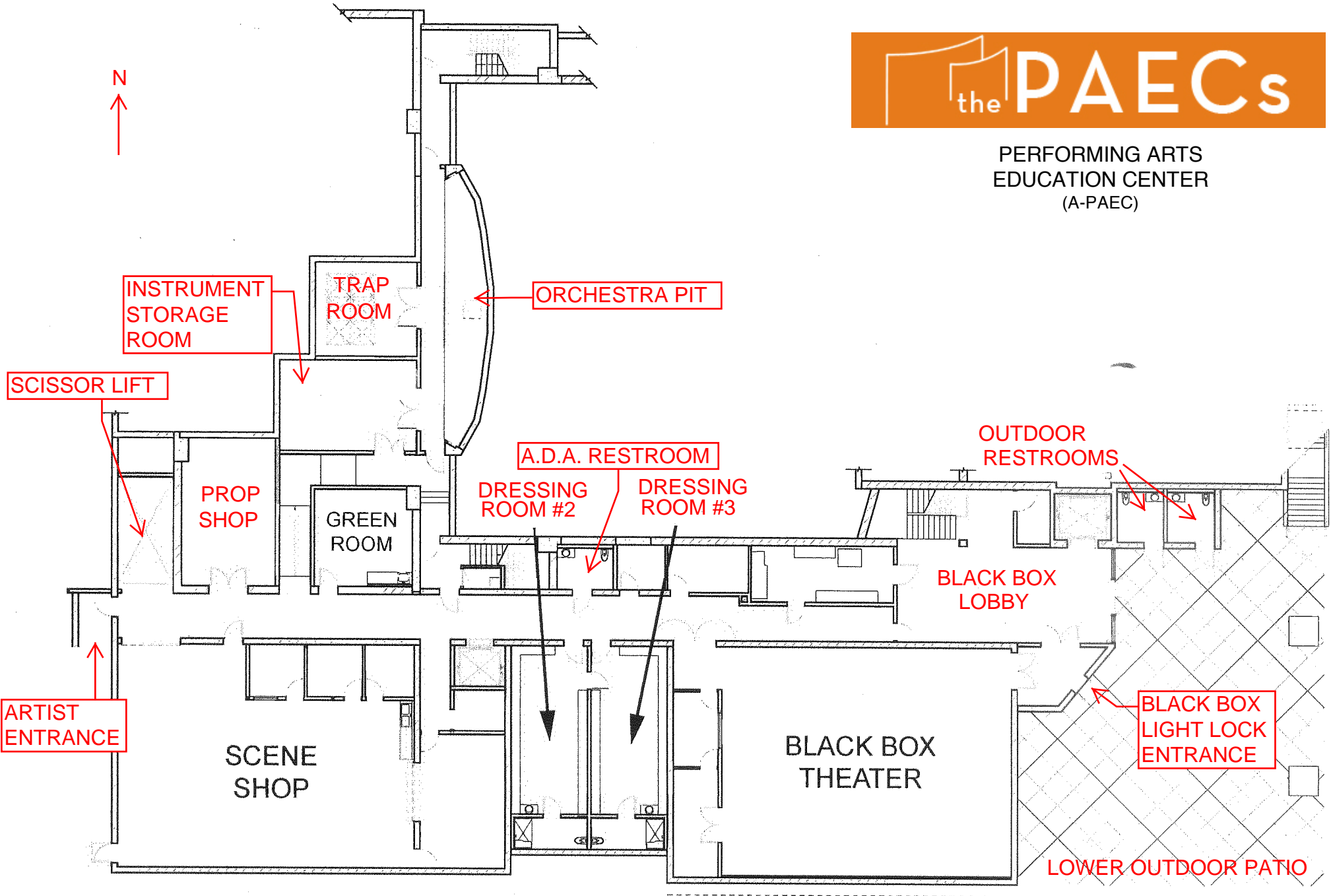

1

FIRST LEVEL PLAN

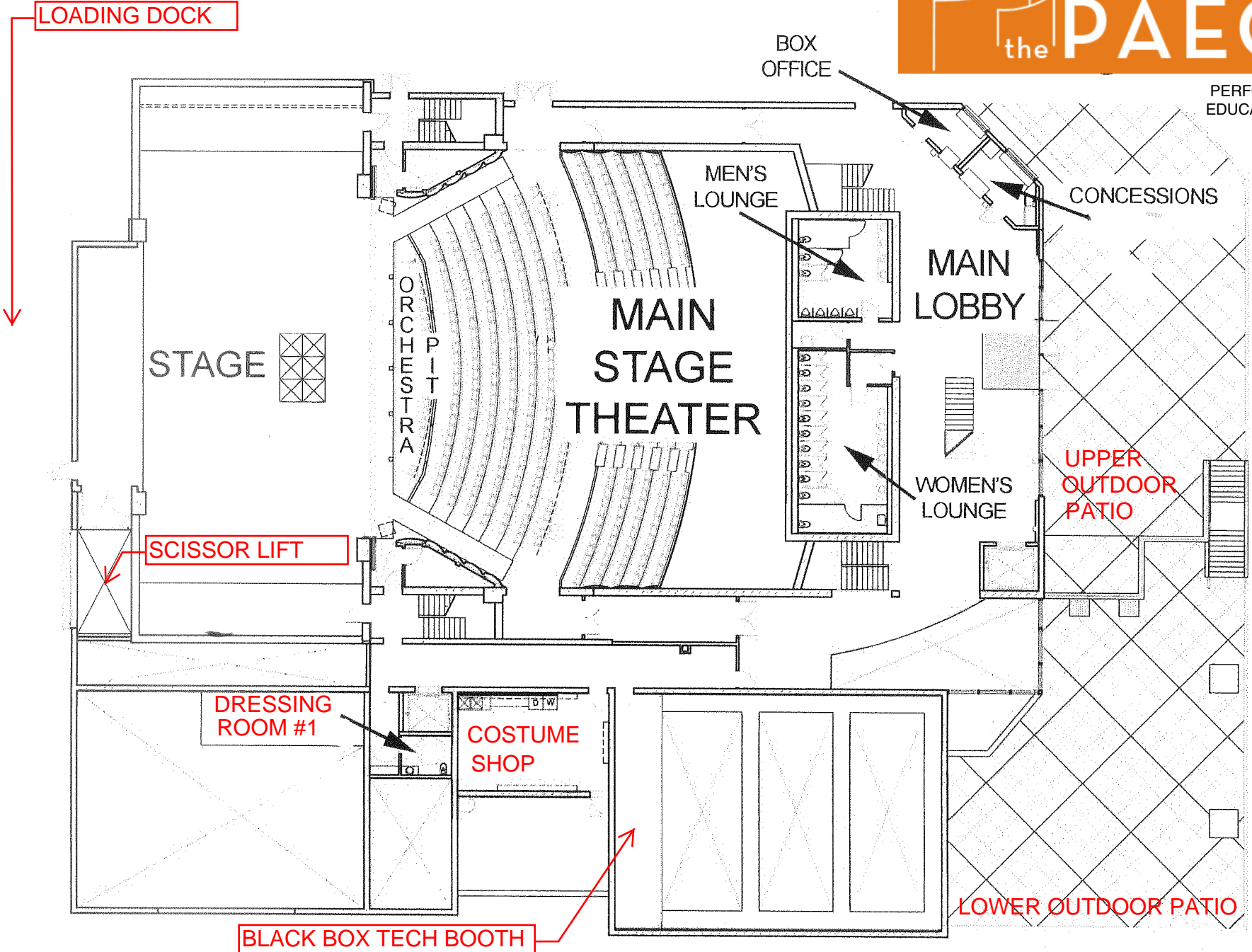

1

SECOND LEVEL PLAN

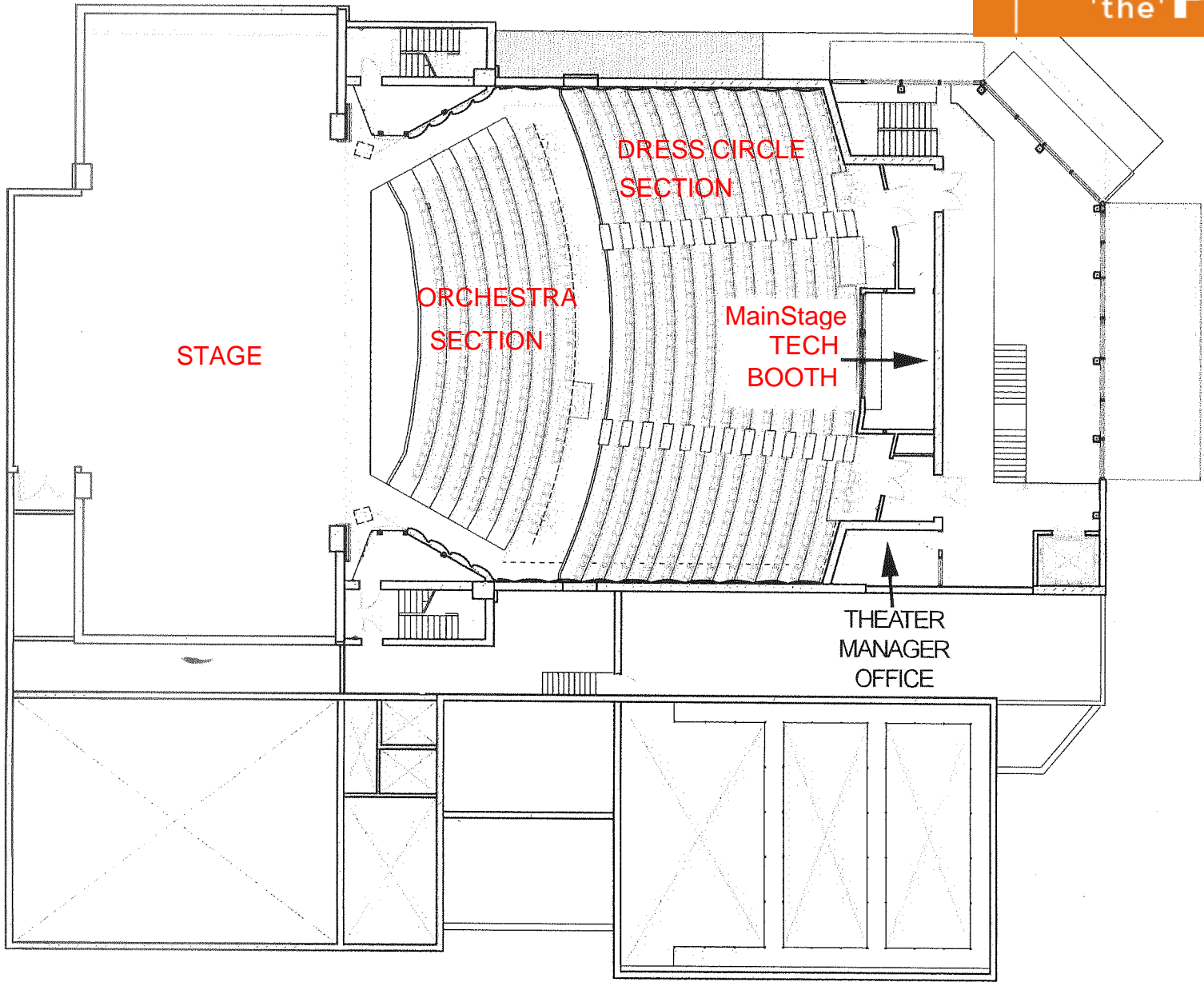

1

THIRD LEVEL PLAN

## **House:**

### Seating Capacity:

- Fixed seating capacity: 653
- Seating Capacity with flexible seating on orchestra lift installed: 686

### Sections

Orchestra Lift Section  
Rows AA & BB: 33 seats

Orchestra Section  
Rows A through G: 209 Seats  
Note: All seats in the Orchestra Section have fold-out tablet arms for use as desks

Dress Circle Section  
Rows H through W: 444 Seats

### Handicap Seating:

- Six (6) wheelchair accessible seats
- Seven (7) transfer seats
- Six (6) dedicated companion seats

### Acoustic Curtains:

The catwalk system above the audience chamber is lined with acoustical curtains, which allow you to customize the reverberance of the MainStage Theater for your event.

### Tech Table Position:

A tech table can be established in the center of the house, Row G, in front of the Main Stage Audience Crossover that separates the Orchestra and Dress Circle sections in the audience chamber

### WiFi

- A WIFI network is available throughout the building for clients.
- Network: LVUSD-PAEC-wifi (Password Available on site)



**Backstage:**

Dressing Room 1:

Located at stage level, accessed from Stage Right in upper hallway, this dressing room has 3 stations including a chair, makeup lights and power outlet.

Dressing Rooms 2 & 3:

Located one floor below the stage, accessed from stage right in lower hallway, each dressing room has 19 stations including a chair, makeup lights and power outlet.

Green Room

Located one floor below the stage, accessed from stage right in lower hallway, this room contains a couch, sink, cabinets, microwave, coffee maker, and a Refrigerator.

## STAGE

### Floor

¼" tempered Masonite over 2 layers of 1 1/8" tongue and groove plywood.

### Critical Dimensions:

- Proscenium Height: 22'
- Proscenium Width: Variable from 59'-6" to 40' Wide
- Useable stage depth from Plaster line: 34'
- Apron edge to plaster line @ CL: 13'-6"
- Clearance Under SR Catwalk: 14'-1"
- Clearance Under SL Locking Rail: 18'-3"
- Grid Height: 55'
- Distance from Grid to battens w/ battens out: 3'-6"

### Orchestra Pit Elevator

The stage is equipped with a Serapid orchestra pit lift. The lift is 7'-4" deep from the tip of the apron (along the CL) and 44'-6" wide on the upstage edge.

#### Lift Capacity

Dynamic Load: 50 lbs./sq. ft. max. 14,000 lbs. Static Load: 150 lbs./sq. ft. max 42,000 lbs.

#### Travel Speed

4.5 feet/min.

#### Built-in stops

The lift has 3 built in stops: stage level, audience seating level(-3'-0"), and orchestra pit level(-9'6").

#### Flexible Seating

33 additional audience seats can be added to the orchestra lift to supplement house capacity from 653 to 686.

**Drapery:**

- 4 Black Velour Legs: 23'H x 8'W
- 4 Black Velour Borders: 66'W x 9'H
- 1 Main Curtain traveler, Blue velour: 28'H x 34'-6"H (x2)
- 2 full-stage traveler curtains, black velour: 23'H x 34'-6"W (2 each)
- 1 Gray Sharkstooth Scrim: 66'W x 24'H (available for rent)
- 1 Black Sharkstooth Scrim: 66'W x 24'H (available for rent)
- 1 White Vinyl Cyclorama 66'W x 24'H

**Company Switch**

**1)** 400 amp, three-phase, five wire, 120/208V company switch. Connection is Cam-Lok or bare leads. Located on the upstage right wall.

**2)** 100 amp, three-phase, five wire, 120/208V company switch. Connection is Cam-Lok or bare leads. Located on the upstage right wall (typically used for cyc lights).

**Orchestra Shell**

Wenger "Diva" Acoustical Shell System

**Dance Floor**

Harlequin "Cascade" Vinyl Dance Floor



## **RIGGING**

### Single-Purchase Counterweight Line Sets:

(See theatre groundplan and line set schedule for more details.)

32 counterweight line sets total with locking rail located Stage Left.

- 2 line sets dedicated to the overhead orchestra shell panels
- 4 line sets dedicated to electrics with overhead raceways
- 2 line sets dedicated to side ladder lighting pipes
- 24 general purpose line sets

Point load capacity on G.P. battens: 133 lb.

Total load capacity on G.P. battens: 1750lb.

### Prodigy Hoist

- Motorized electric batten. Approx. 4'-0" downstage of plaster line.
- Point load capacity: 170 lbs. 1550 lb. max capacity.

### Transverse line sets (Light Ladders)

Two line sets positioned 2'-2" offstage of the ends of the battens, running up and down stage are dedicated, in the Rep Plot, as side lighting ladders.

### Line Set Schedule (next page):

- 'G.P.' indicates 'General Purpose' battens
- (xxx) indicates Rep Plot usage/house hang

Distance U.S.  
of Plaster

Line set #	Line	Content
1	1' - 2"	G.P. (Projection Screen)
2	1' - 10"	Main Curtain
3	3' - 2"	Electric #1
4	4' - 8"	G.P.
5	No Arbor	-
6	5' - 8"	G.P. (Border #1)
7	6' - 4"	G.P. (Legs #1)
8	7' - 0"	G.P.
9	8' - 4"	Orchestra Shell #1
10	9' - 6"	G.P.
11	11' - 0"	Electric #2
12	No Arbor	-
13	13' - 0"	G.P.(Border #2)
14	13' - 8"	Midstage Traveler
15	No Arbor	-
16	15' - 0"	G.P.
17	16' - 4"	G.P.
18	No Arbor	-
19	18' - 4"	G.P. (Electric #3)
20	19' - 8"	G.P. (Border #3)
21	20' - 4"	G.P. (Legs #3)
22	21' - 1"	Orchestra Shell #2
23	23' - 0"	G.P.
24	24' - 2"	Electric #4
25	n/a	SR Ladder
26	26' - 4"	G.P.
27	n/a	SL Ladder
28	27' - 8"	G.P. (Border)
29	28' - 4"	Upstage Traveler
30	29' - 0"	G.P.
31	29' - 8"	G.P.
32	30' - 4"	RP/Cyc
33	No Arbor	-
34	32' - 4"	G.P.
35	33' - 0"	G.P.
36	33' - 8"	G.P.
37	34' - 4"	G.P. Electric #5

## LIGHTING

### Control

Main stage lighting console is an ETC *Ion* 1500 with 2x20 fader wing.

### Data

ETC Net 3 Ethernet network with multiple RJ45 patch points throughout the theatre.

### Main Dimmer Racks

2 ETC Sensor Racks, 214 Dimmers in main stage theatre. Dimmer room is located on the stage right side of the catwalk level above the house.

### Portable Dimmer Rack

Portable ETC Sensor Pack with 24 dimmers is located on the stage right catwalk that controls the cyclorama lights on the 5<sup>th</sup> electric upstage of the cyc.

### Distribution

Consult the theatre repertory lighting plot for detailed information.

### 4 onstage dedicated electrics

Each onstage electric has an overhead raceway with stage pin connectors, 2 ETC net ports, 120V, and 208V power.

### #0 electric (Prodigy Hoist)

ETC net, stage pin connectors, 110V, and 208V power

### Cyc Lights "5<sup>th</sup> Electric"

A G.P. line set upstage of the cyc has been designated for the cyc lights, per the Rep Plot.

### 3 APs (Front of House Electrics)

ETC net, stage pin connectors, 110V, and 208V power.

### 2 Box Booms/Side Lighting Positions

Downstage of the proscenium, stage pin connectors, ETC net port, 110V power

### Light Ladders

The Light Ladder Battens are perpendicular to the proscenium 2'-2" off-stage right and left. Each pipe has 4 light ladders supplied by Socapex from the grid.

### Net 3 Gateway Nodes

Three (3) portable nodes are available to supply an additional universe of channels (512 channels) over ethernet and/or to adapt DMX to ethernet.

### Rep. Plot

The PAEC maintains a repertory lighting plot encompassing our entire instrument inventory to provide versatile and comprehensive lighting for various events. If any fixtures are changed for a production they must be restored to their original focus and position during strike/restore.

#### Inventory: (In repertory light plot configuration)

Qty.	Instrument Type	Wattage
7	Source Four Zoom, 15 deg.-30 deg.	750
7	Source Four, 10 deg.	750
20	Source Four, 14 deg. DimmerDouble	550/77v
12	Source Four, 19 deg.	575
40	Source Four, 19 deg. DimmerDouble	550/77v
105	Source Four, 26 deg.	575
64	Source Four, 36 deg.	575
8	Source Four, 50 deg.	575
50	Source Four PAR mfl DimmerDouble	550/77v
5	12 cell - 4 circuit Ground Cyc	750
8	4 cell Sky-Cycs	1000

### Follow Spot Lights

- 2 Lucidellaribalta (LDR) Canto 1200s. 1200W spotlight with 5 color gel changer, iris, and shutter.
- 2 Source Four, 10deg mounted on follow spot yokes.

### Circuit Layout

See chart on the following page.

AHS PAEC Circuit Location Map  
Tech Booth Point of View

Note: All Circuits **Normally** Dimmer Doubled in **BOLD**.  
Note: All Circuits **Normally** unassigned/spare in **RED**.

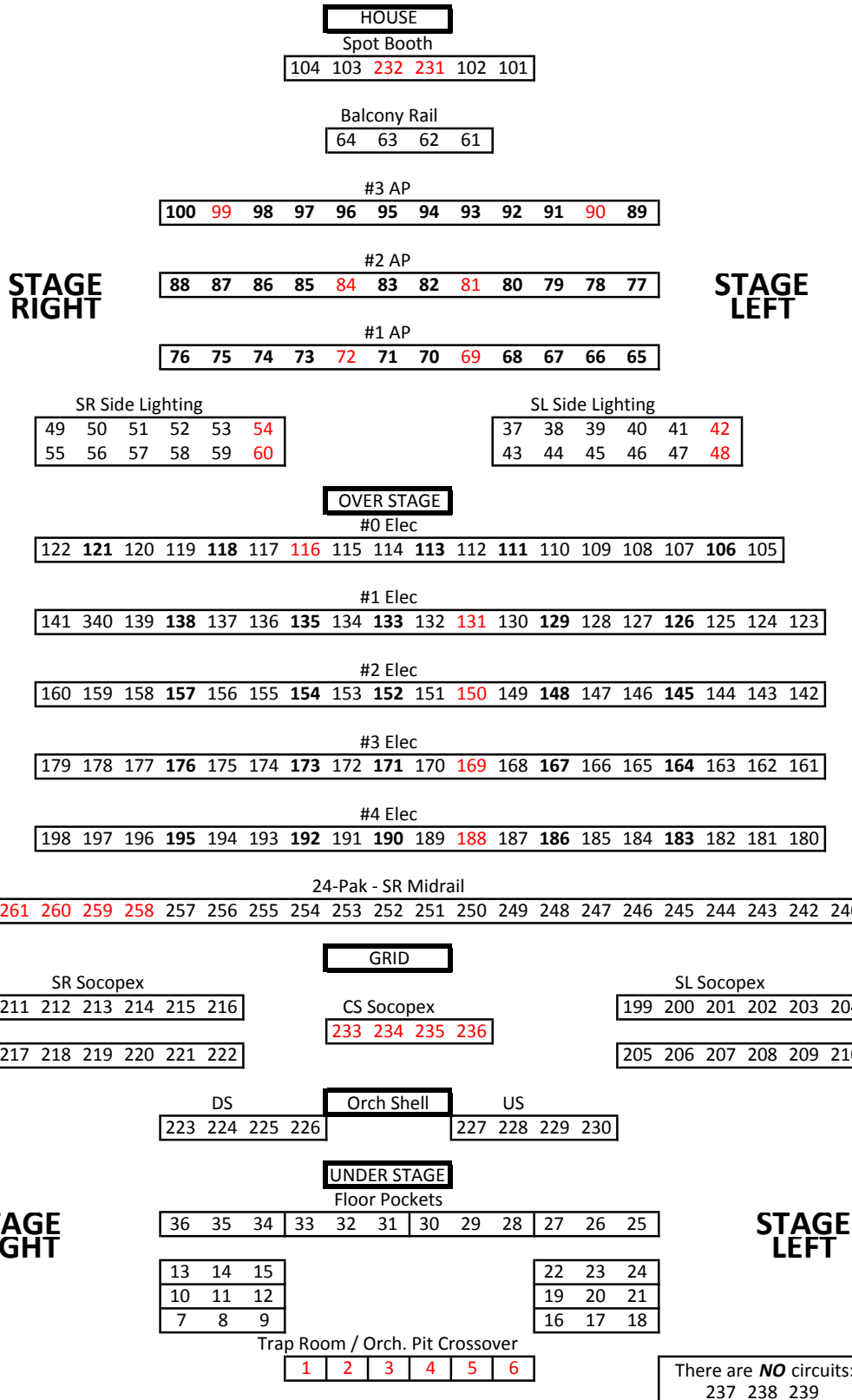

## **AUDIO**

### Mixing Console

Yamaha M7CL-48 ES

### **Amplification**

- QSC Line Arrays house right and house left: 8 QSC WL2082-I loudspeakers per array.
- Sub-woofers: 2 QSC GP118-sw sub-woofers
- Portable Speakers (monitors): 0 Renkus-Heinz SGX121 passive monitor speakers

### Playback/Recording:

Mac Mini

OSX (Maverick) Mac Mini with Q-lab video/audio playback software, iTunes, and QuickTime

### Qlab Compatible Audio File Types

- iTunes Audio (.m4a, .m4b, .m4p)
- mp3
- Core Audio (.caf)
- AIFF
- AU
- SD2
- WAV
- SND
- AMR

Tascam CD Player/Recorder

### Distribution

Ethersound Digital Audio Network

### XLR Patching

48 board inputs patchable from various XLR ports throughout the theatre

## Mic Lines

### 60 XLR "Mic" inputs

- 12 inputs on proscenium left box
- 12 inputs on proscenium right box
- 12 inputs on upstagecenter wall box
- 24 inputs in 2 orchestra pit floor pockets

## Tie Lines

### 46 male and female XLR ports patchable as inputs or outputs

- 4 tie line ports on backstage right box
- 4 tie line ports on backstage left box
- 4 tie line ports on upstage wall box
- 8 tie line ports in orchestra pit floor pockets
- 2 tie line ports on light lock right wall box
- 2 tie line ports on light lock left wall box
- 2 tie line ports on up house right wall box
- 2 tie line ports on up house left wall box
- 2 tie line ports in Trap Room
- 12 tie line ports on Catwalks
- 4 tie line ports on Grid

## **Monitor Patching**

### 6 amp-outs patchable to various Speakon NL4 ports throughout the theatre:

- 4 speakon ports on proscenium right box
- 4 speakon ports on proscenium left box
- 4 speakon ports on upstage center wall box
- 2 speakon ports in orchestra pit floor pocket

## Microphone Inventory

Qty.	Microphone:	Type:
8	Shure SM58	Dynamic Cardioid Vocal Mic
4	Shure Beta 57A	Dynamic Supercardioid Mic
4	SM81	Cardioid Condenser Instrument Mic
4	Sennheiser MD-421	Dynamic Cardioid Mic
4	DPA 4061	Omni Condenser Instrument Mic Kit
5	Crown PCC-160	Cardioid Condenser Floor Mic
4	Audio-Technica U853R	Cardioid Condenser Hanging Mic
	<b>Shure DMK57-52 Drum Mic Kit:</b>	
1	-Beta 52A	Kick Drum Mic
3	-SM57	Drum Mic
	<b>Wireless Mics:</b>	
8	DPA 4066 Headset Omni Mics	
8	DPA D-fine Headset Omni Mics	
16	ULXD2 (Beta 87A) Wireless Handheld Mic	
16	ULXD1 Wireless Bodypack Transmitter	
4	Sennheiser ew 300 G3 Handheld wireless Mic	

## Audio Equipment Inventory:

### Mic Stands:

- Eighteen (18) 37"-57" Ultimate Support Pro-SB Mic Stands
- Five (5) 16"-23" Three-leg stands
- Five (5) 8" Desk Stands

### DI Boxes:

- 4 Stereo DI boxes: stereo XLR in, 1/4" TRS and RCA out
- 8 Mono DI Boxes



## **PROJECTION**

### Front Projection

#### Projector

Panasonic DLP DZ21 21K lumen Projector. Typically projected onto front projection screen (32'Wx20'H).

#### Playback

- The FOH Projector may be connected to the Mac Mini show control computer at the sound board for video playback through Qlab, Quicktime, etc.
- Or, the FOH projector may be connected to any computer/player with a mini-display port, HDMI, VGA, DVI, or RCA connection.
- Local RJ45 network allows for video source to be located at various positions throughout the theatre. (i.e. backstage, tech booth, catwalk, etc.)

#### Video Files compatible with QlaB

- QuickTime Movie (.mov)
- MPEG-4 (.mp4, m4v)
- MPEG-2
- MPEG-1
- 3GPP
- 3GPP2
- AVCHD
- AVI
- DV

### Rear Projection System

6 Projector Array, rear-projected onto RP/cyc.

#### Projectors

6 Panasonic DLP DZ7700 7K lumen Projectors

#### Watchout Show Control

Dataton WATCHOUT media servers, software, and control system are available to utilize full functionality of integrated rear projection.